

NLB Connector

For Non-Load Bearing Wall to Truss Connections

The FastenMaster Non-Load Bearing (NLB) Connector is a system for attaching non-load bearing walls to trusses and joists above.

Quick Installation

The NLB Connector allows the installer to easily make this non-load-bearing lateral connection in one step. Replacing the current method, it requires no pneumatic nail guns or hoses. Installation is up to 10x faster than traditional methods.

Safety

This connection can be completed with just one fastener while standing on the subfloor, eliminating the need for ladders.

Code Compliance

The NLB system is code-compliant and backed by state specific stamped documents.



NLB movement during load transfer from above and below



NLB Connector[™]
For Non-Load Bearing Wall to Truss Connections



NLB Connector™

For Non-Load Bearing Wall to Truss Connections

GENERAL GUIDELINE

- For use in wood to wood connections only.
- A minimum of 2 NLB connections should be used on any wall regardless of length.
- Connections should be made within 24" of either end of non-load bearing walls unless connected to perpendicular load bearing walls. In these cases, a maximum end distance of 48" should be used.
- NLB Setting Tool required for proper installation.
- Although the vertical movement between the truss and framing is typically less than 1/4", consideration must be given to allow for this variance in semi-rigid surfaces or drywall. The most common methods for achieving this fall under three categories:
 - 1) The use of resilient channels or hat channels mounted perpendicular to the trusses. Guidelines for the use of this flexible metal furring can be found in bulletin GA-227-13 on the American Gypsum Association website www.americangypsum.com
 - 2) Installation of clips at the top of the walls in conjunction holding back of drywall fastening from the ceiling to wall joint. Some of the most commonly used clips can be found here:
 - a. Prest-on Corner-back Clips: www.prest-on.com/products/corner-back
 - b. Simpson Strong-Tie DS Clip: www.strong-tie.com
 - c. Mitek DC-1 Clip: www.mitek-us.com
 - 3) Details where cove or crown molding is mounted to the ceiling but unaffixed to the wall
 - 4) Reference TER# 1907-08 at drjcertification.org

NLB SYSTEM

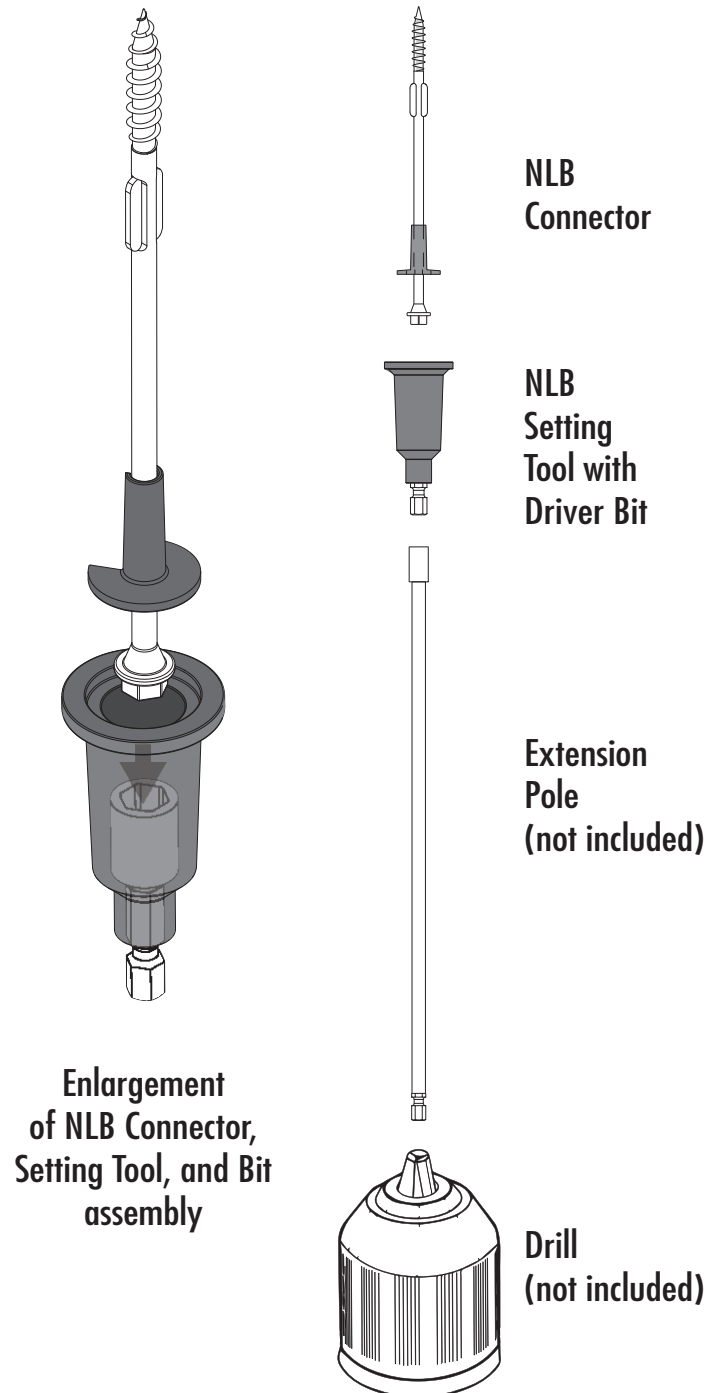

Enlargement of NLB Connector, Setting Tool, and Bit assembly

NLB Connector

NLB Setting Tool with Driver Bit

Extension Pole (not included)

Drill (not included)

SKU	Description
FMNLB006-50	(50) Preassembled screws with sleeves (1) Setting Tool and (1) Driver Bit

FM19429 (0220)

FASTENMASTER
800-518-3569

153 BOWLES ROAD, AGAWAM, MA 01001
WWW.FASTENMASTER.COM

FastenMaster® and NLB Connector™ are trademarks of OMG, Inc. Copyright © 2020 OMG, Inc. All rights reserved. U.S. Patent No. 9,360,032 and Patent Pending. Bit made in Taiwan. All other components manufactured in the USA using globally sourced materials.