

**DESIGNER NOTES**

Connections made using LedgerLOK Screws (FMLL358, FMLL005) with minimum 1-1/4" thread embedment into EW rim or 1-1/2" into dimensional rim, staggered top and bottom at spacing corresponding to open joist span supported at the ledger per Table.

**COMPLIANT TO CODES**

IRC, IBC, LABC, LARC, FBC, FRC

**SUPPORTING TECHNICAL REPORTS**

ICC-ES Evaluation Report ESR-1078 (<https://icc-es.org/report-listing/esr-1078/>)  
 DRJ Technical Evaluation Reports TER 1203-03, (<https://www.drjcertification.org/company/fasten-master/>)

LIVE LOAD	LEDGER MATERIAL	RIM BOARD TYPE	SPACING BETWEEN FASTENERS (IN) BY MAXIMUM OPEN JOIST SPAN							
			6 ft	8 ft	10 ft	12 ft	14 ft	16 ft	18 ft	
40	D.FIR S.PINE	2X LUMBER	24	18	14	12	10	9	8	
		EW RIM	25	19	15	12	10	9	8	
	HEM FIR SPF	2X LUMBER	20	15	12	10	8	7	6	
		EW RIM	25	19	15	12	10	9	8	
60	D.FIR S.PINE	2X LUMBER	17	13	10	8	7	6	5	
		EW RIM	18	13	10	9	7	6	6	
	HEM FIR SPF	2X LUMBER	14	11	8	7	6	5	4	
		EW RIM	18	13	10	9	7	6	6	

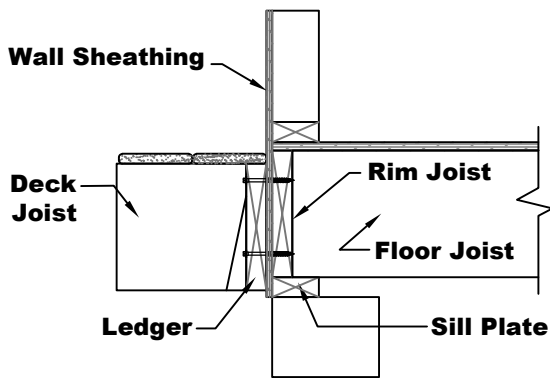

**SECTION VIEW**

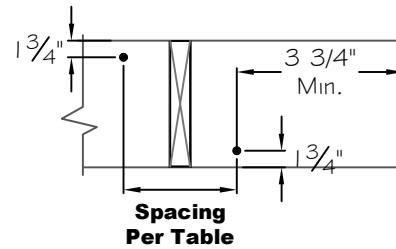

**FRONT VIEW**

**DECK LEDGER TO RIM BOARD**

**DETAIL #  
FM - LL01**

**REV. DATE  
04/14/2023**

**FastenMaster Framing Details**

